

**« Turnkey »
platform
assembly line
for RAFALE**

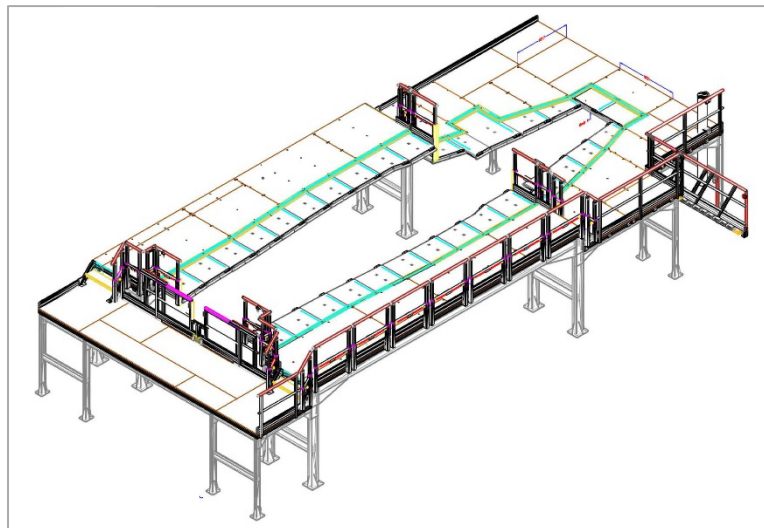

3D view of the complete platform



Platform with 2 levels - length 15 370 mm, useful width 2 000 mm with drawers – stroke 600 mm - on plane side.
Painted steel supporting structure fixed on the ground. Upper structure raw aluminum – gangway: wood - thickness 21 mm

Capacity of load: 250 kg/m² - access limited to 10 people.



Head office & Plants : ZI du Muckental – F – 67140 BARR
Phone +33(0)3 88 58 53 53 – Fax +33(0)3 88 58 53 54
www.aeronautique.fortal.fr/en – info@ortal.fr

« Turnkey » platform assembly line for RAFALE



Staircase for access to each level of the platform - grating steps yellow lacquered - rear blocked to prevent any risk of falling objects



Drawers – independent – plane side – are build on ball rails – width 800 mm – sliding underside the fixed platform – level difference by beveled edge flat sheet secured with yellow/black anti-slip strip

Drawers are lockable in position and handling from the underside.

Shockproof protection plane side

Capacity of load: 2 people 200 kg per drawer.

Guardrail with handrail and intermediary rail and baseboard. Side guardrails sliding half-height.



Head office & Plants : ZI du Muckental – F – 67140 BARR
Phone +33(0)3 88 58 53 53 – Fax +33(0)3 88 58 53 54
www.aeronautique.fortal.fr/en – info@ortal.fr

« Turnkey » platform assembly line for RAFALE

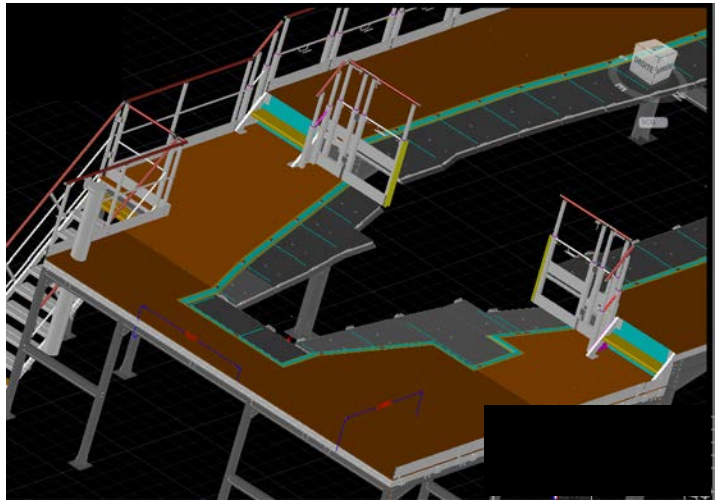

Platform access by integrate staircase –
usefull width 800 mm – grating aluminum steps
1st and last step yellow lacquered – security
gate access upstairs



Platform – front side view
Each platform is equipped with:

- Y connections
- Pneumatical roller systems
- wastes evacuator
- Electrical boxes with plugs
- lights
- LED light under the platform
- Main electrical control box
- Slidding topping winches.



Head office & Plants : ZI du Muckental – F – 67140 BARR
Phone +33(0)3 88 58 53 53 – Fax +33(0)3 88 58 53 54
www.aeronautique.fortal.fr/en – info@ortal.fr

« Turnkey »
platform
assembly line
for RAFALE

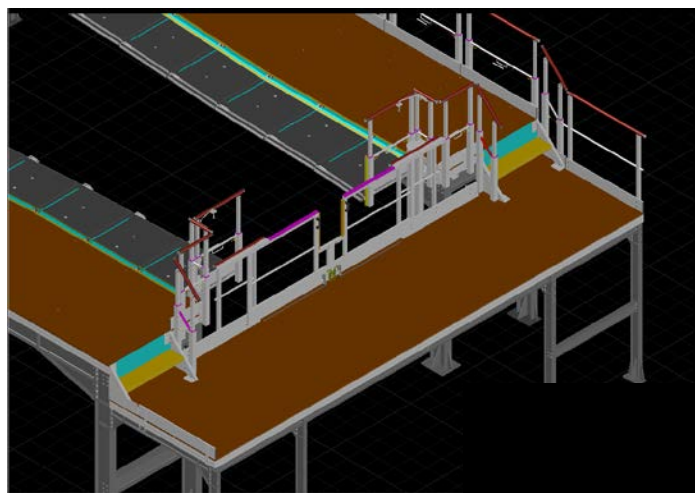

Platform – rear side view.
Woods panels – brown, anti-sliping – white color painting for more
lightness under the platform.



Head office & Plants : ZI du Muckental – F – 67140 BARR
Phone +33(0)3 88 58 53 53 – Fax +33(0)3 88 58 53 54
www.aeronautique.fortal.fr/en – info@ortal.fr