

# Left/right tail dock access Falcon F7X

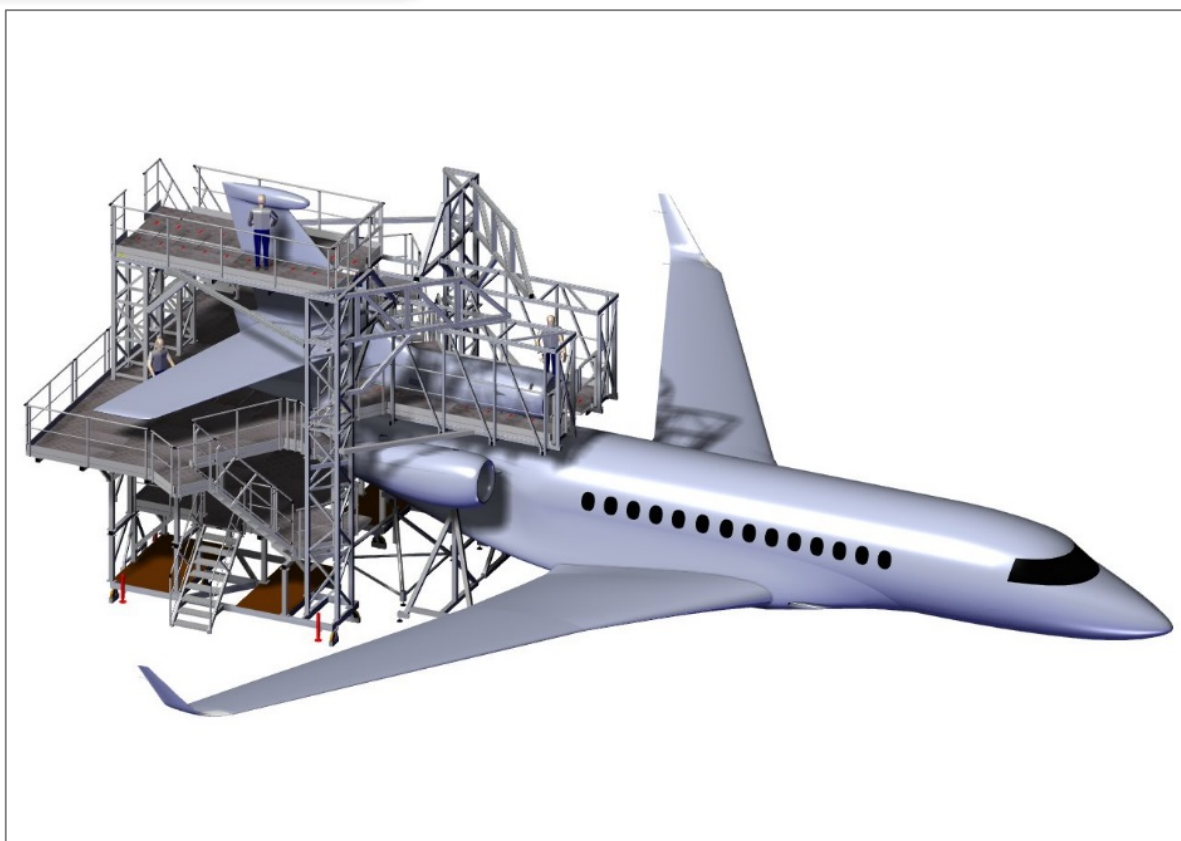

Realization composed of 2 side-access with 4 levels: 1 616 – 3 890 – 4 416 and 6 840 mm.

- Aluminum and steel main structure
- Capacity of load: 4 people and tooling levels 1 and 2 : 900 kg
- Capacity of load: 1 people levels 3 and 4 : 150 kg

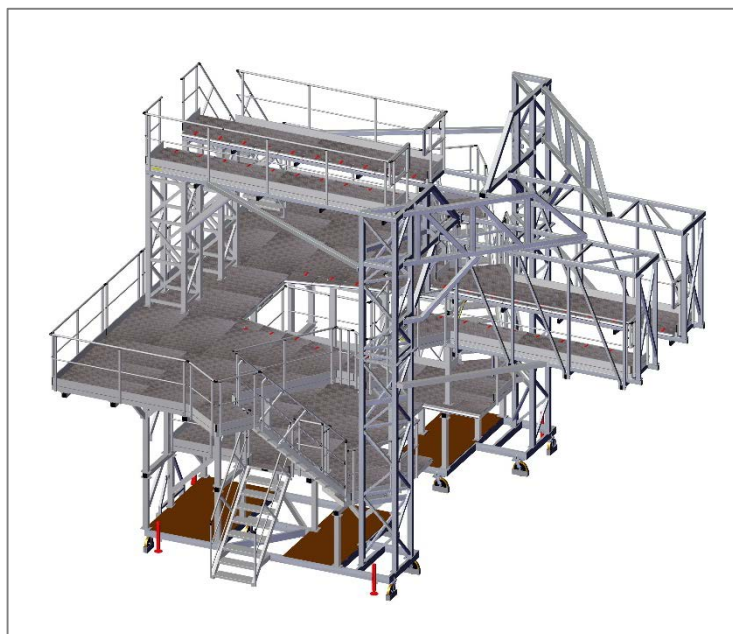

Head office & Plants : ZI du Muckental – F – 67140 BARR  
Phone +33(0)3 88 58 53 53 – Fax +33(0)3 88 58 53 54  
[www.aeronautique.fortal.fr/en](http://www.aeronautique.fortal.fr/en) – [info@ortal.fr](mailto:info@ortal.fr)

# Left/right tail dock access Falcon F7X



Lockable towbar with resistance against vibration – in raised position - maximum speed for towing: 5 km/h



Aluminum anti-slip platform  
2<sup>nd</sup> level equipped with sliding drawers every 50 mm - locking in position - designed to conform perfectly the shape of the plane and shockproof protection .

Capacity of load: 1 people/150 kg on each drawer.



Half tail dock :

- Aluminum guardrail height 1 100 mm with handrail – intermediary rail and baseboard
- Aluminum staircase with anti-slip grating steps depth 230 mm

 **FORTAL**<sup>®</sup>  
[www.fortal.fr](http://www.fortal.fr)  
DIVISION AERO  Made in France

Head office & Plants : ZI du Muckental – F – 67140 BARR  
Phone +33(0)3 88 58 53 53 – Fax +33(0)3 88 58 53 54  
[www.aeronautique.fortal.fr/en](http://www.aeronautique.fortal.fr/en) – [info@ortal.fr](mailto:info@ortal.fr)

# Left/right tail dock access Falcon F7X

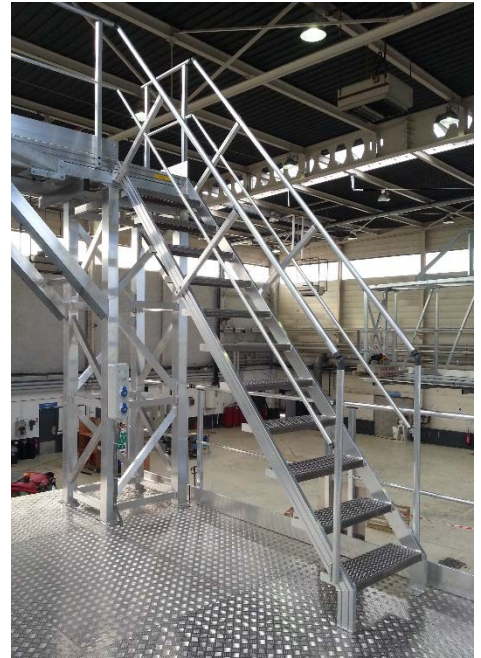

Stepladder width 700 mm for 4<sup>th</sup> level access.



- Each tail dock equipped with:
- Immobilization cranks with foldable handle
  - Swivel brake wheels Ø 300 mm – blocking 4 x 90° – with foot protection



- Turnkey delivery with:
- Light on 1st level: LED light IP 67
  - Electrical panel with 3 plugs including a domestic plug.
  - 1 plug for pneumatic pressure



Head office & Plants : ZI du Muckental – F – 67140 BARR  
Phone +33(0)3 88 58 53 53 – Fax +33(0)3 88 58 53 54  
[www.aeronautique.fortal.fr/en](http://www.aeronautique.fortal.fr/en) – [info@ortal.fr](mailto:info@ortal.fr)

**Left/right  
tail dock access  
Falcon F7X**



Sliding guardrail to be near optimum to the wing



Half tail dock part is tow to the point of use



Head office & Plants : ZI du Muckental – F – 67140 BARR  
Phone +33(0)3 88 58 53 53 – Fax +33(0)3 88 58 53 54  
[www.aeronautique.fortal.fr/en](http://www.aeronautique.fortal.fr/en) – [info@ortal.fr](mailto:info@ortal.fr)